

THE DRAWINGS AND INFORMATION CONTAINED HEREIN ARE THE EXCLUSIVE PROPERTY OF ACTEL. THE INFORMATION, DRAWINGS AND DESIGN CONCEPTS CONTAINED HEREIN ARE CONFIDENTIAL/PROPRIETARY, SHALL BE MAINTAINED IN STRICT CONFIDENCE, AND SHALL NOT BE RELEASED TO ANY THIRD PARTY WITHOUT THE EXPRESS WRITTEN PERMISSION OF ACTEL.

REV.	DESCRIPTION OF CHANGE	DATE	ORIGINATOR
0	Initial	5/6/99	Ray Kung

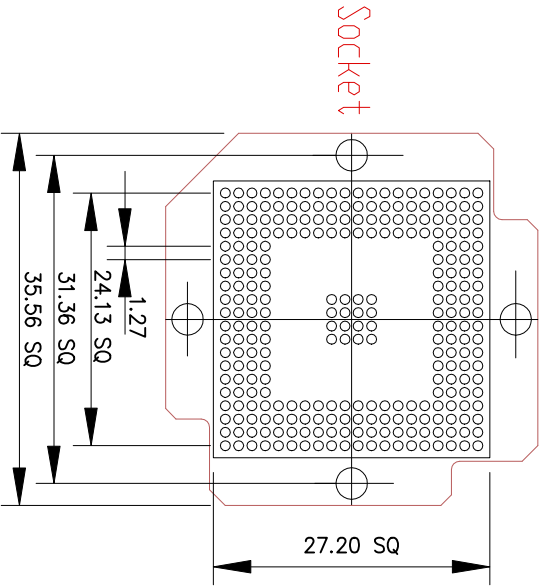
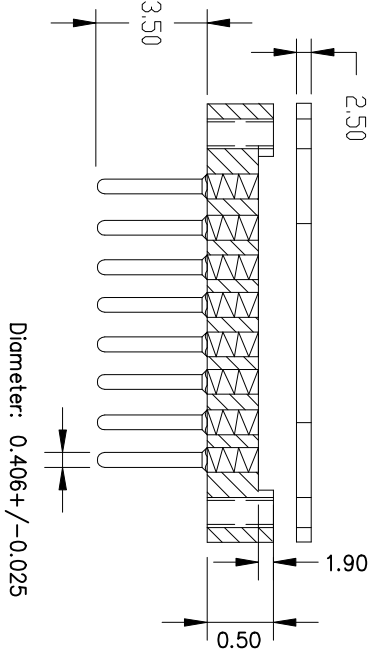

- NOTES: Dim: mm
- PIN MATERIAL: BRASS ALLOY 360, 1/2 HARD.
 - PIN FINISH: 10 μ" GOLD OVER 50 μ" NICKEL.
 - INSULATOR MATERIAL: FR-4 GLASS EPOXY
 - Contact: BeCu with gold plated

ACTEL CONFIDENTIAL

UNLESS OTHERWISE SPECIFIED DIMENSIONS ARE IN MILLIMETERS	ANGULAR
XX ±0.10	±1°
X.XX ±0.05	
X.XXX ±0.03	
MATERIAL	SEE NOTES
FINISH	SEE NOTES
DO NOT SCALE DRAWING	

PRODUCTION	APPROVALS	DATE
	Ray Kung	4/27/99
DESIGNED		
ENGINEER		
RELEASED		

ACTEL CORP 955 E ARQUES AVE SUNNYVALE CA 94086	TITLE	ACTEL DWG. NUMBER	REV
	272-27 x 27mm, 1.27mm E-TEC BGA SOCKET	1-07-09038	0
	SIZE: 272-27 x 27mm, 1.27mm E-TEC BGA SOCKET		
	VENDOR MAKE: E-TEC		
	VENDOR SID(PART) NUMBER: BPV272-1270-20AB11		
	VENDOR DWG. NUMBER		
	Scale: NONE		
	SHEET 1 OF 2		

E-TEC PART#: BPV272-1270-20AB11
E-TEC PATENTS PENDING